

Stadtportalhäuser

Design Competition
Frankfurt am Main, Germany



1

This gateway project is located at the intersection of a major boulevard into the city of Frankfurt and the edge of a large international exposition center. The mixed-use program includes an office building and museum for the Bosch Corporation, two speculative office buildings and a hotel. The complexity and volumetric configurations seen in the design resolution were influenced both by the importance of maintaining the site trees and an open park space, and the existing railroad bridge, road system, and exposition structures.

The design produced a compelling plan graphic and massing collage of varying scales and multiple images. The silhouettes viewed from a distance and the impression

of the architecture as a whole is reinforced by the more immediate experiences at grade and the complexities of the land and building intersections.

Essential to the project's composition and image are two similar wedge-shaped office buildings whose facades define the gate, and the dissimilar masses that extend from these facades to either side of the boulevard.

As the first European competition for our office, the scale and complexity of the architectural and urban resolutions represent a learning and research experience. The issues and strategies explored were an excellent resource for future investigations.

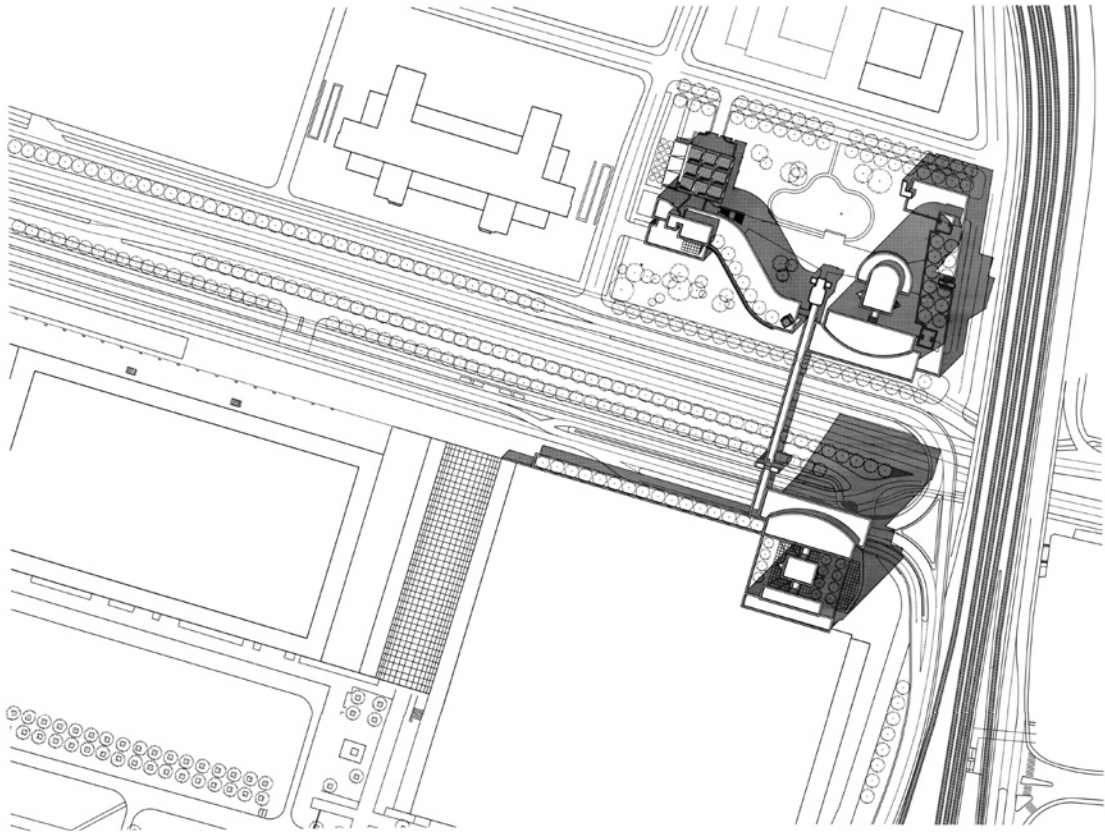

Site plan



Aerial view of model from southeast

Stadtportalhäuser

Design Competition



Aerial view of model from northeast



Ground level view of model from east

Stadtportalhäuser

Design Competition



Aerial view of model from north

Stadtportalhäuser

Design Competition

Key Project Information

- Urban gateway
- Mixed-use complex
- Office buildings
- Museum
- Hotel
- Parking
- High-rise and low-rise facilities
- Contextual response
- Collage of forms

- completion 1994
- gsf 2,000,000

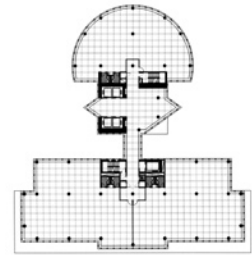

Typical upper level plans of North-site office building

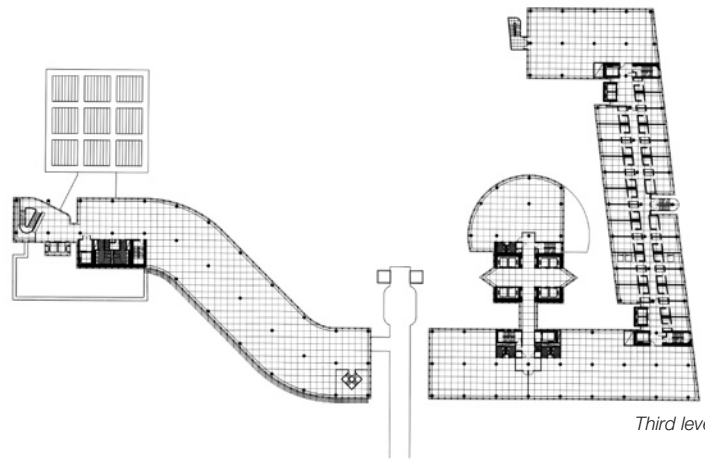

Third level plan

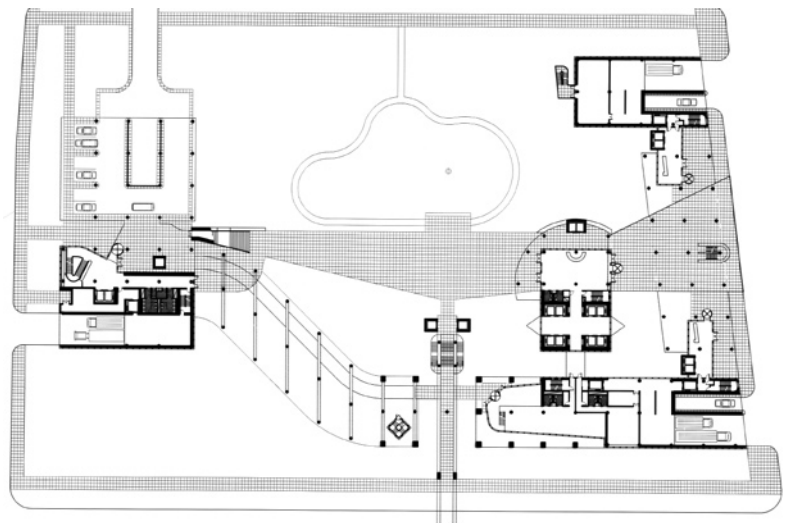

Overall ground level plan