

## Nanyang Polytechnic

Singapore



1

This 2.5 million-square-foot university, situated on a 75-acre site, provides space for the Polytechnic administration and four academic Schools: Engineering, Health Sciences, Business Management, and Information Technology. Supporting common facilities include a 140,000-square-foot, 50,000-volume library, a 1,200-seat auditorium, a sports center, a student center, student dining facilities, a cultural center, and a 105-unit faculty housing structure. Nanyang's mission is to bring over 12,000 students together with faculty, business and industry leaders in an interactive educational community.

The campus is a state-of-the-art facility with the latest communication infrastructure of multimedia video, voice, data and telecommunication links and a comprehensive building automation system. The campus design carefully separates pedestrian and vehicle circulation. A central

building with common facilities (Library, Auditorium, Student Activity Center, Lecture Theaters, Canteens, Child Care and Staff Centers) is connected to individual Schools by a system of gardens, terraces and covered walkways. A loop road system provides parking and service to each individual building.

The Northern Campus includes The School of Engineering and Information Technology. The Southern Campus includes The School of Business, School of Health Science, Student Activity and Sport's Facilities.

All main facades and window areas have external sun control overhangs and are oriented to the north and south to minimize solar heat gain.



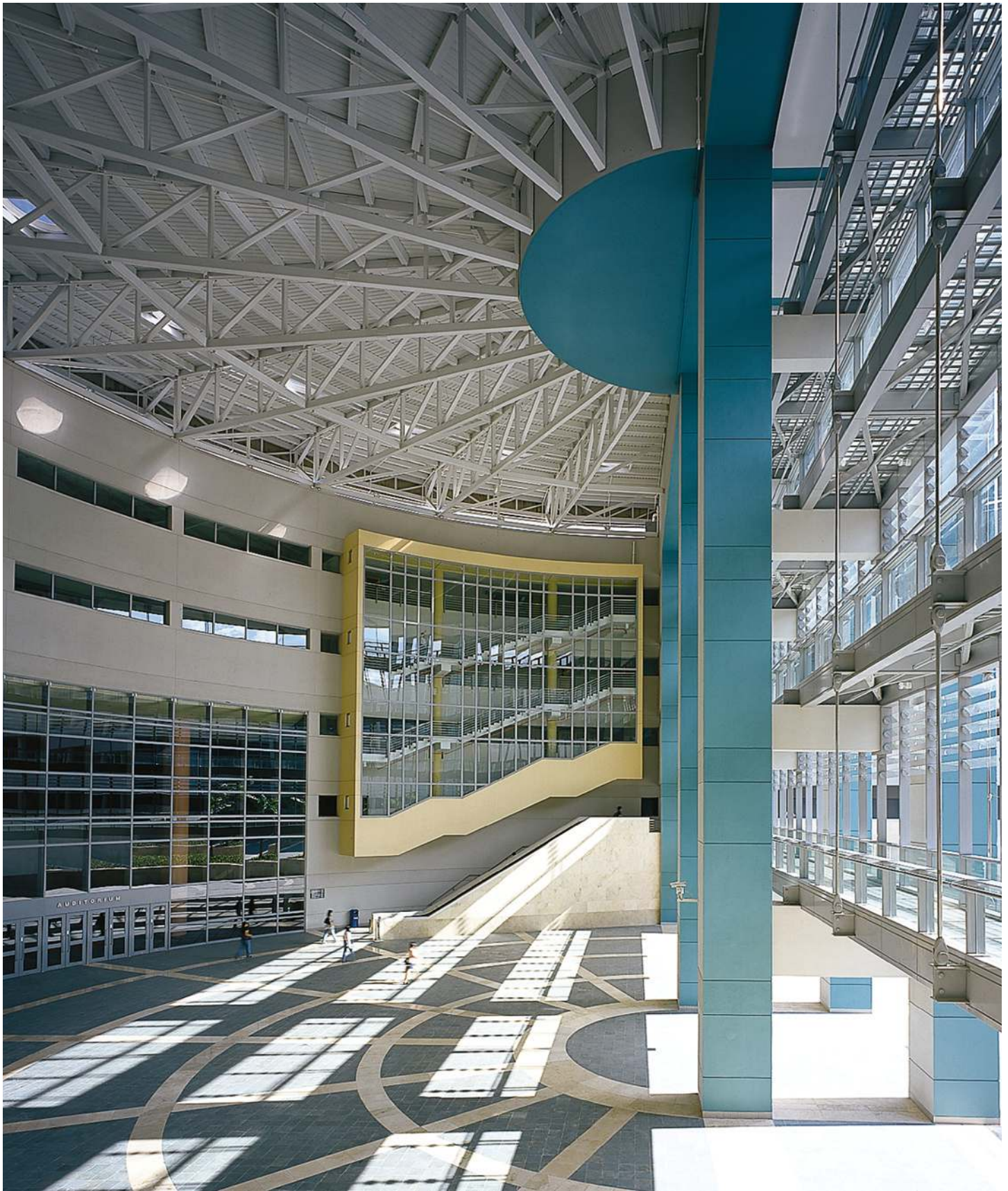

Central campus atrium





Pedestrian bridge





Lower level reflecting pool at pedestrian entry level



Central garden



Southern courtyard toward campus center





1200-seat performance theater



## Nanyang Polytechnic

### Key Project Information

- 140,000 square foot general academic library
- comprehensive indoor/outdoor sports center
- 1,200-seat flexible auditorium
- student center with double-height atrium
- lecture theaters
- state-of-the-art communications infrastructure
- landscaped water courtyard
- childcare center
- student dining facilities
- faculty housing
- comprehensive building automation system
- expansive sites allow for 25% growth

- completion 1999
- gsf 2,500,000

Associate Architect  
DP Architects, Singapore



South Garden at night

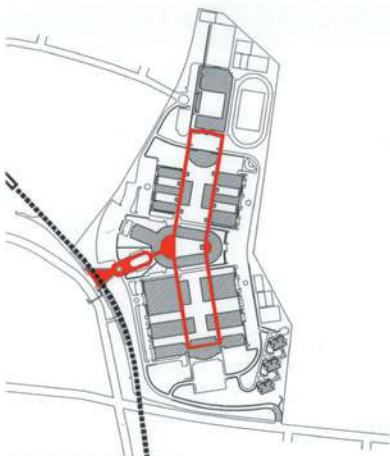
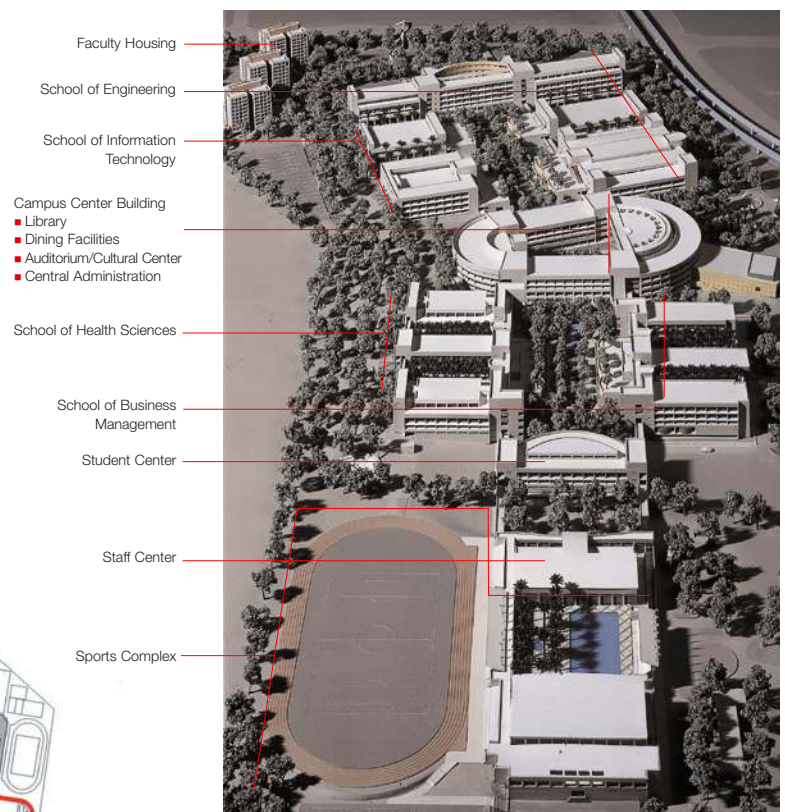

Pedestrian Circulation



Vehicular Circulation