

**WALT DISNEY WORLD**

Convention and Exhibition Center  
Lake Buena Vista, Florida



*Entry plaza and vehicular entry arcades*



1



2

Disney World's Convention and Exhibition Center represents a significant and independent addition to an existing complex of hotel and meeting facilities.

As such it was required to accomplish a dual agenda; resolving its own complex programmatic charge at the same time that it reconfigured a composition of earlier buildings and public spaces and gave them a renewed vitality. The critical device in responding to this latter public consideration was the design of a 2.5 acre entry plaza which links the older building to the new and leads to a new porte-cochere entry for the Hotel.

The entry plaza - with its elaborate paving patterns, carefully orchestrated landscaping and imposing, curved entry canopy - becomes the unifying element in the entire 'urban' composition. It is a truly public space on a grand scale which brings the disparate architectural pieces of the Center into a fully realized formal relationship.

The new addition contains a 45,000-square foot main ballroom that holds 3,300 people and can be divided into three multipurpose spaces: a

7,000-square foot ballroom, three prefunction spaces, five meeting rooms, and a full-service kitchen with loading facilities. Reinforced by a strong color palette, the Convention Center's horizontal silhouette contrasts with the vertical, gridded facade of the Hotel. Four major forms create the collage-assemblage: the curved, striped primary volume of the main ballroom and prefunction gallery; the entry canopy; and the two rotundas. One rotunda connects to the Hotel with stairs, escalators and a glass-block bridge; the other is accented by a square-punched window, an iconic form on the more visible West corner.

1 South rotunda from hotel

2 Detail of vehicular entry arcade, main roof and north rotunda

# WALT DISNEY WORLD

## Convention and Exhibition Center



Overall view from Lake Buena Vista

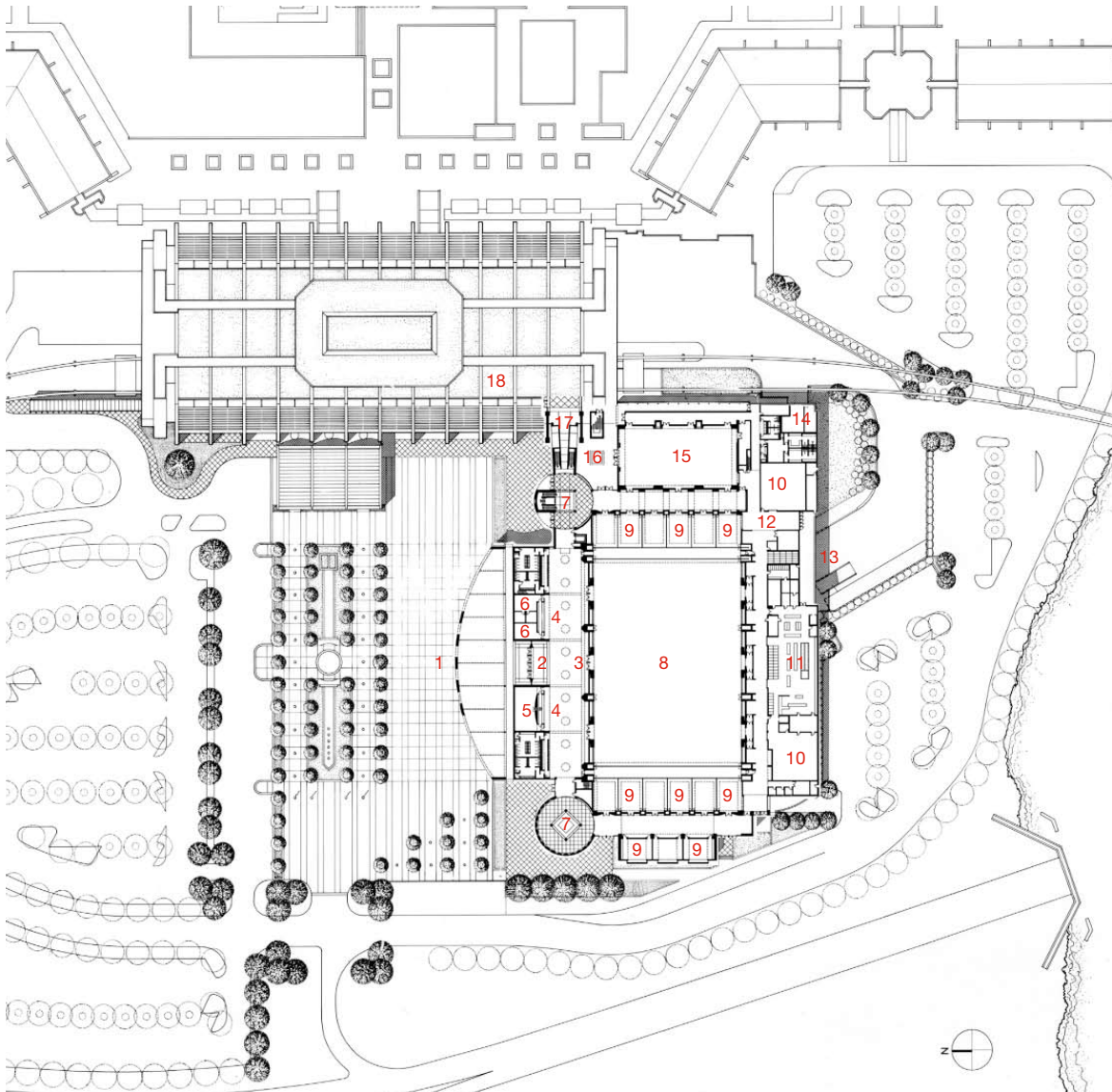

- 1 entry plaza
- 2 lobby
- 3 main pre-function
- 4 reception
- 5 conference room
- 6 business center
- 7 rotunda
- 8 main ballroom
- 9 meeting room
- 10 storage
- 11 kitchen
- 12 receiving
- 13 loading dock
- 14 staff lounge
- 15 junior ballroom
- 16 east lobby
- 17 hotel connection
- 18 hotel



*Interior of North rotunda*



*Main ballroom*



*South rotunda with escalator and bridge connection to hotel*

**WALT DISNEY WORLD**

Convention and Exhibition Center

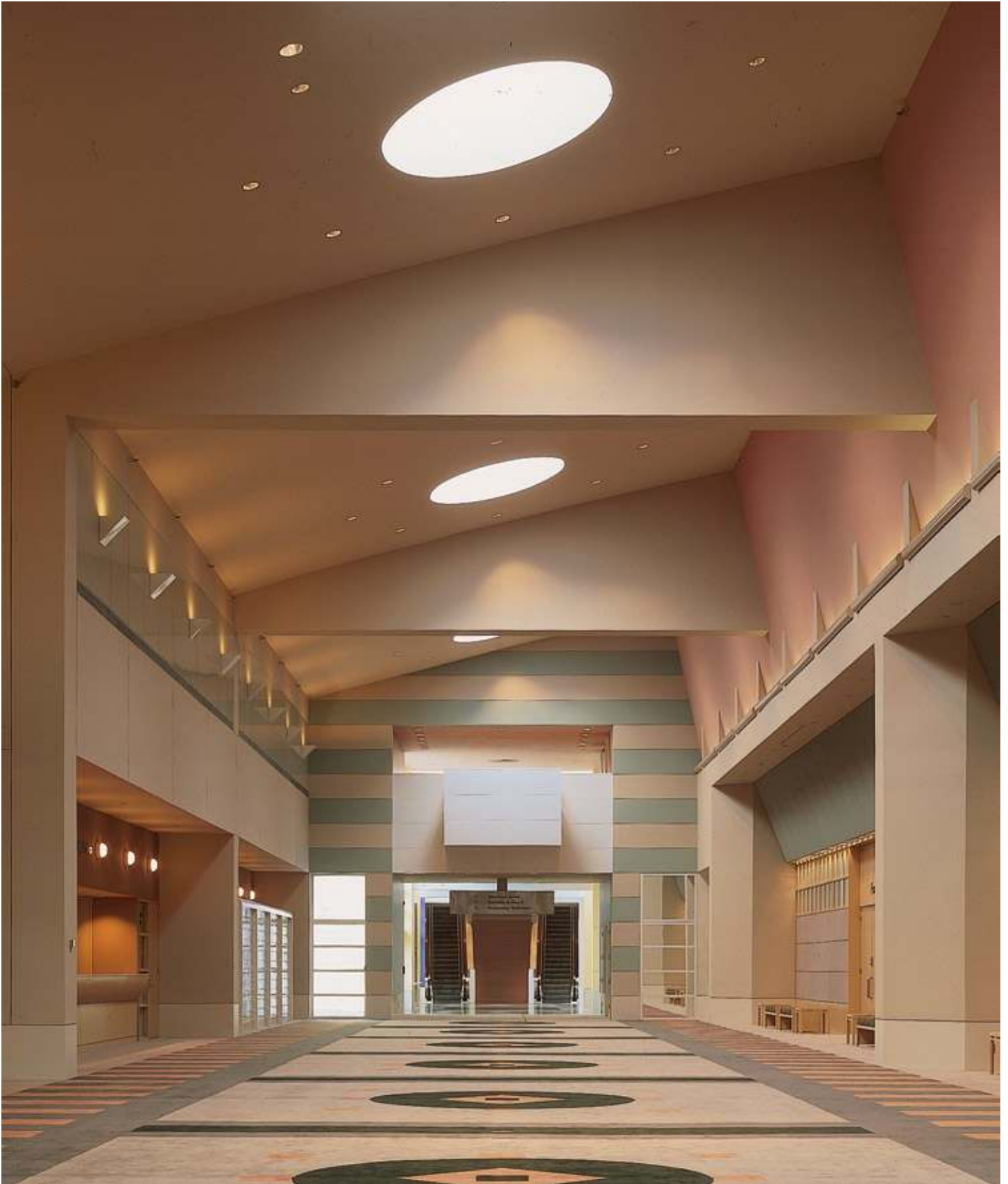

*Main prefunction space*

## WALT DISNEY WORLD

Convention and Exhibition Center

### Key Project Information

- 2.5-acre entry plaza
  - 44,300-square foot, flexible main ballroom accommodating 3,300 people
  - “Junior” ballroom
  - Porte-cochere
  - Double height lobby
  - Business center
  - Green room
  - Star dressing room
  - Audio visual department
  - Five conference/meeting rooms
  - Full kitchen with loading and storage facilities
  - Loading dock/holding and receiving area
  - Employee lounge
- 
- completed: 1991
  - gsf: 120,000

### Developer

The Walt Disney Company

*“The firm’s success in breaking the mold of monolithic exteriors is surpassed only by the richness of the center’s interior.”*

*Architecture Magazine, January 1992*

*1992 Distinguished Architecture Award, AIA, New York Chapter*



*North facade*