

Middlebury College

Middlebury College Library
Middlebury, Vermont



1

The new Middlebury College Library is the first step to fulfilling the College's master plan for the development of a campus intellectual and social center. The library is a state-of-the-art research and learning facility, combining a traditional print collection with the latest communications technology. Located on the eastern edge of the Front Quad, the facility also establishes a new campus center and enhances the existing relationship between both the College and the Town.

The three-story, 143,000-square-foot facility accommodates the increasing use of technology in teaching and research. It also provides expansion space for the College's growing collection of printed materials to support evolving curriculum needs.

The library is architecturally consistent with the other buildings on the historic front quadrangle in both its materials—limestone,

granite and marble—and its scale. The project reconfigures a composition of existing roadways, buildings and prominent public spaces, establishing a new campus center that fits into existing view corridors and pedestrian circulation routes.

Library interiors provide efficient and flexible space that will serve the College's needs well in to the next century. This includes increased seating to accommodate planned growth in the student body. Because of the importance of interactive and collaborative learning in the residential liberal arts environment, most seating is in group study and meeting rooms.

In keeping with Middlebury College's overall concern for contextual and environmentally sensitive design, the project is designed to meet a high rating for the LEED (Leadership in Energy & Environmental Design) standard for environmental efficiency.



View from Route 30 to Front Quad



View from Academy Green to Front Quad

Middlebury College
Middlebury College Library



West facade



Upper level terrace and west reading room



Entry rotunda

Middlebury College
Middlebury College Library



View of entry rotunda from upper level



View from lower level reading space of stair and atrium above



Upper level study carrels and stacks, South corridor



Rare book reading room



Typical tower carrel room

Middlebury College
Middlebury College Library



West reading room



Upper level study carrels and stacks



Upper level study carrels and stacks, South corridor

Middlebury College

Middlebury College Library

Key Project Information

- anchor building for new intellectual and social campus complex
 - façade of granite, limestone and marble
 - expansion space for print collection
 - state-of-the-art technology infrastructure
 - expanded seating areas for group study and meetings
 - designed to meet the LEED Silver Standard
-
- completion 2004
 - gsf 143,000

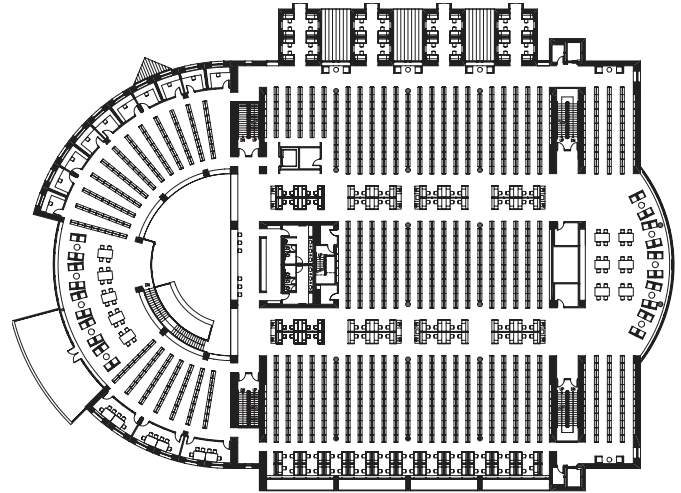

Upper level plan

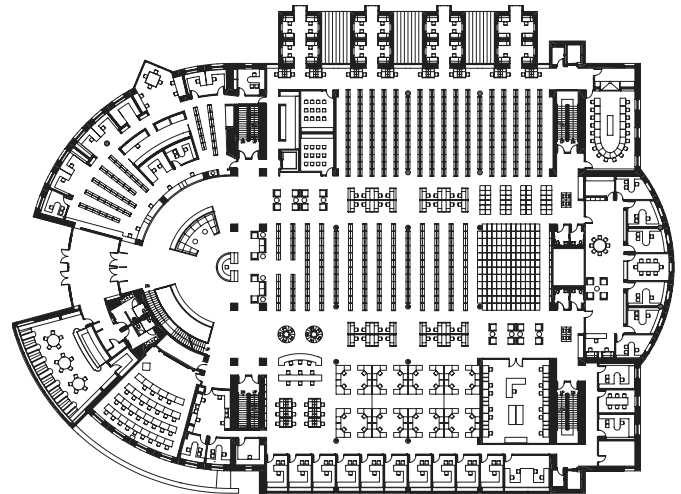

Quad level plan

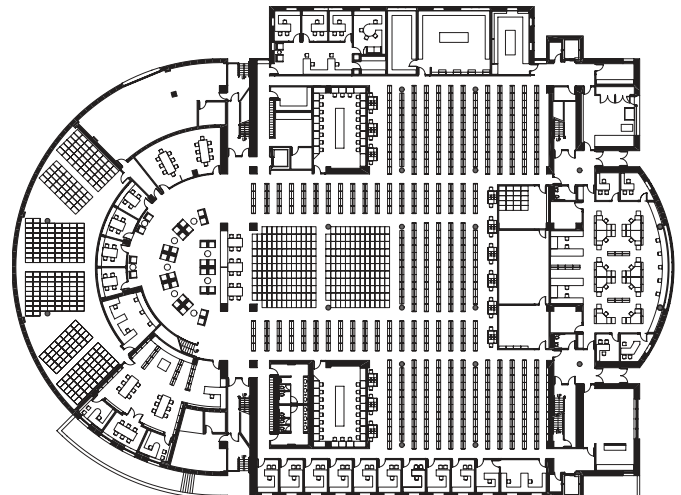

Lower level plan



View through carrel towers